

# 8" COREFLOOR

## FIGURES INDICATE SUPERIMPOSED LOADS

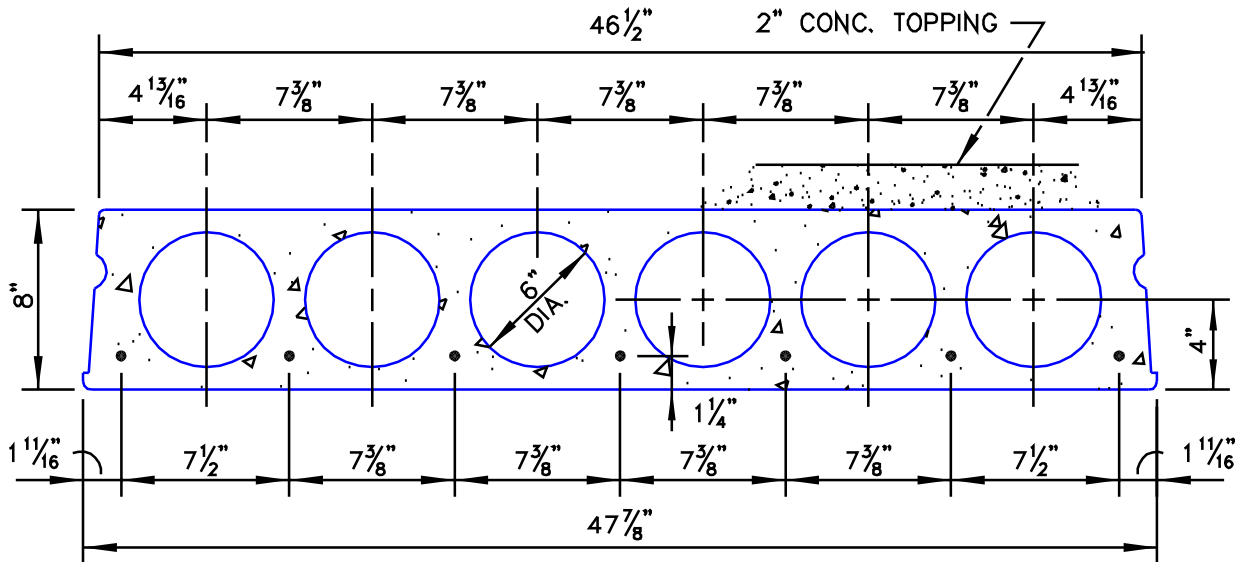

### SECTION PROPERTIES

NON-COMPOSITE  
 A= 214 IN.<sup>2</sup>      I= 1666 IN.<sup>4</sup>  
 Y<sub>B</sub>= 4.0 IN.      WT= 56 PSF  
 Y<sub>T</sub>= 4.0 IN.

COMPOSITE  
 A= 310 IN.<sup>2</sup>      I= 3084 IN.<sup>4</sup>  
 Y<sub>B</sub>= 5.30 IN.      WT= 80 PSF  
 Y<sub>T</sub>= 4.70 IN.

SPAN IN FEET													
STRAND	18'	20'	22'	24'	26'	28'	30'	32'	34'	36'	38'	40'	42'
8SC46	116	85	62	45									
8SC47	170	129	99	76	58	43							
8SC48		182	143	112	89	70	55	43					
8SC58			185	148	120	97	78	63	51	40			
8SC68				183	149	122	100	83	68	56	45		
8SC78					179	148	123	102	85	71	59	49	40
8ST46	142	102	73										
8ST47	210	158	119	89	66								
8ST48		225	174	136	106	82	63						
8ST58			228	181	144	115	92	73					
8ST68				224	181	147	119	97	76				
8ST78				264	215	177	145	120	96	76			

**SUPERIMPOSED LOAD CAPACITY IN POUNDS PER SQUARE FOOT**

f<sub>ci</sub>= 3500 PSI  
 f<sub>c</sub>= 6500 PSI  
 STRAND= 270 KSI L.R.

CONCRETE TOPPING= 4000 PSI  
 SC- UNTOPPED SECTION  
 ST- 2" COMPOSITE TOPPING