

# 10" COREFLOOR

## FIGURES INDICATE SUPERIMPOSED LOADS

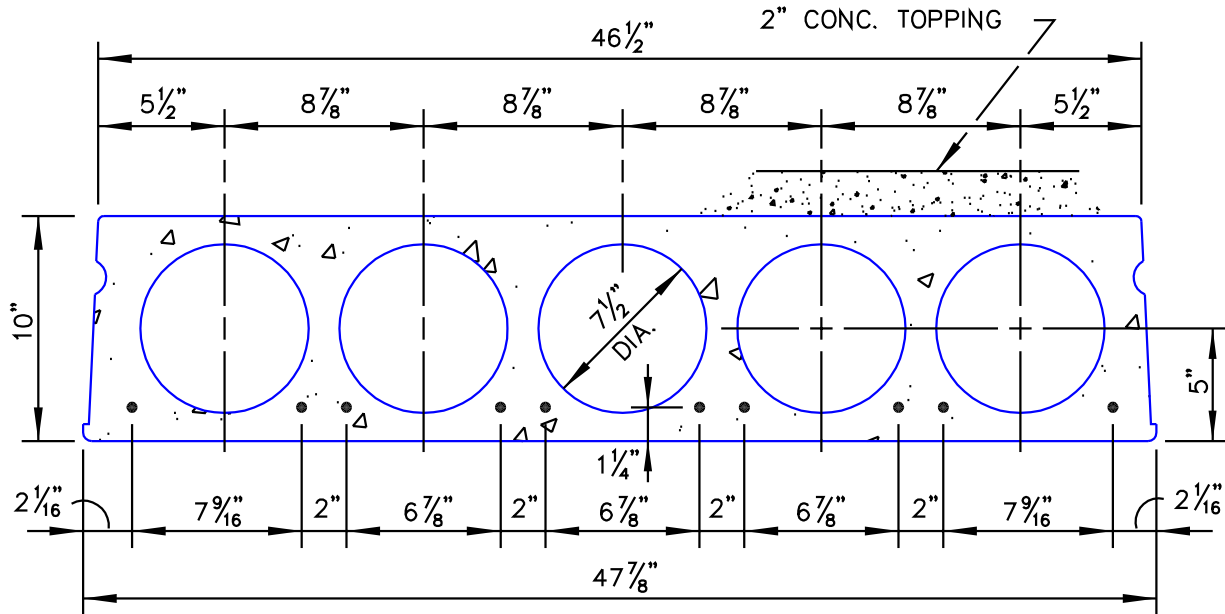

### SECTION PROPERTIES

<u>NON-COMPOSITE</u>		<u>COMPOSITE</u>	
A= 259	IN. <sup>2</sup>	I= 3223	IN. <sup>4</sup>
Y <sub>B</sub> = 5.0	IN.	WT= 67	PSF
Y <sub>T</sub> = 5.0	IN.	Y <sub>B</sub> = 6.35	IN.
		WT= 91	PSF
		Y <sub>T</sub> = 5.65	IN.

### SPAN IN FEET

STRAND	28'	30'	32'	34'	36'	38'	40'	42'	44'	46'	48'	50'	52'
10SC58	133	109	89	73	59	47							
10SC68	168	139	116	96	80	66	54	44					
10SC78	201	168	141	119	100	84	70	59	48	40			
10SC 26/88	232	195	164	139	118	100	85	72	61	51	42		
10SC 26/98	263	222	188	160	137	117	100	86	73	62	53	44	
10SC 26/108	291	247	210	180	154	133	114	99	85	73	62	53	45
10ST58	152	122	98	78	62								
10ST68	192	158	129	106	86	70							
10ST78	231	192	159	132	110	91	75	61					
10ST 26/88	269	225	188	158	133	111	90	72					
10ST 26/98	304	255	215	182	154	130	108	88	71				
10ST 26/108		284	240	204	174	148	125	104	86	70			

### SUPERIMPOSED LOAD CAPACITY IN POUNDS PER SQUARE FOOT

f <sub>ci</sub> = 3500 PSI	CONCRETE TOPPING= 4000 PSI
f <sub>c</sub> = 6500 PSI	SC- UNTOPPED SECTION
STRAND= 270 KSI L.R.	ST- 2" COMPOSITE TOPPING